

47 POWER

THE ALLIANCE OF
COMFORT AND SPEED



**NAUTITECH**
ELEVATE YOUR DREAM

COMFORT

STYLISH AND ELEGANT INTERIOR

Space has been reimagined to offer an unrivalled liveaboard experience. A warmer woodwork, a variety of materials, and a multitude of storage spaces, are all welcome features of this new option for the power catamarans market. An interior steering station will enhanced the comfort and create a motor yacht atmosphere. The cabins are light and airy thanks to the double hull windows and multiple openings on the outside. Comfort and privacy are ensure via private bathrooms for each cabin.



PERFORMANCE

FASTER, FURTHER,
FOR EVEN MORE PLEASURE

22 knots top speed with two 300 hp Volvo engines
and a range of 300 miles at 15 knots
and 1000 miles at 8.5 knots



The 47 Power represents the best balance of all the advantages of NAUTITECH catamarans : cruising performance, comfort, safety and, in addition, speed.
Definitely, a catamaran that will seduce you.



A fluid deck layout with generous sunbathing and welcoming spaces guaranteeing an unforgettable experience on board.
An XXL Flybridge offering exceptional comfort with a large solarium, a lounge area with bar and a steering position.
Optimized hull lines for a perfect finish, stability and exceptional comfort at sea whatever the speed.



LIFESTYLE

THE PLEASURE OF SHARING

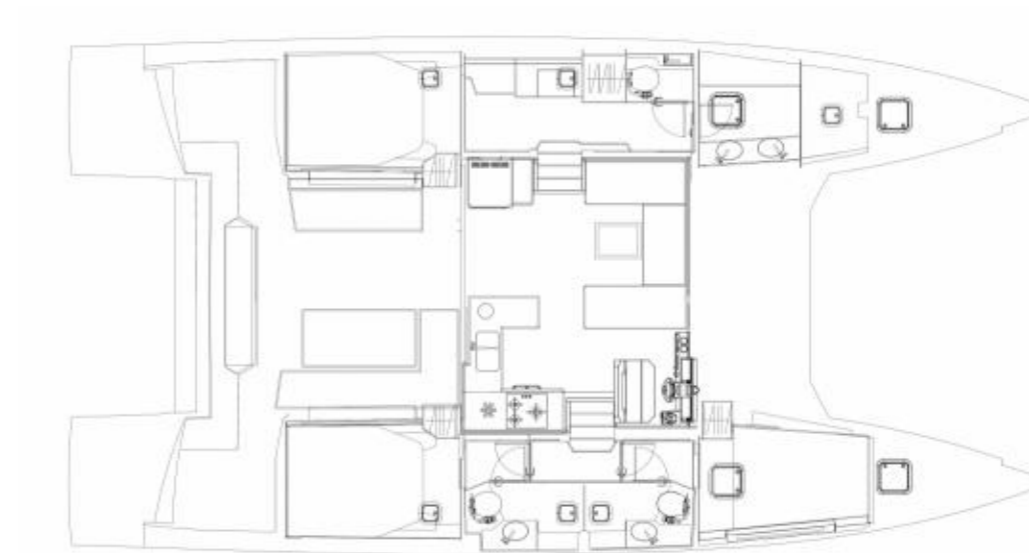

3 cabines

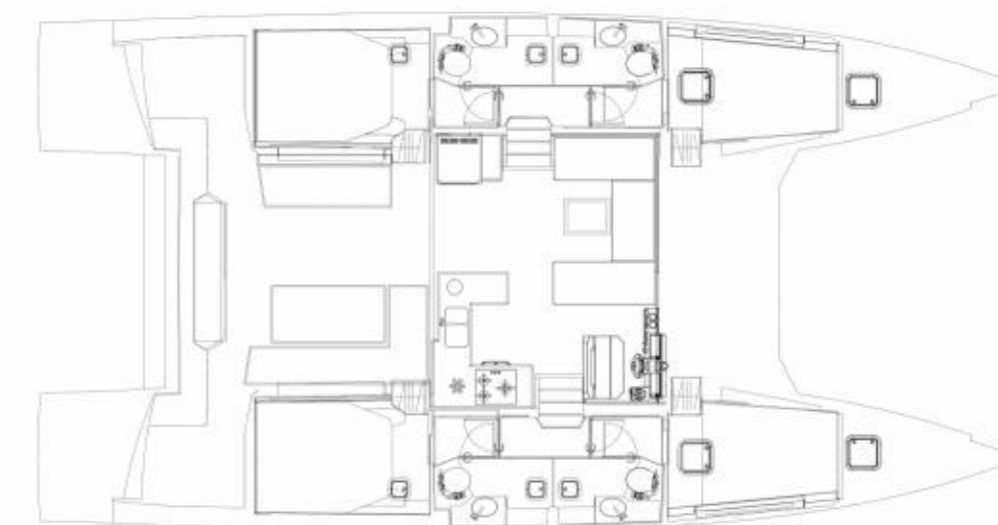

4 cabines

TECHNICAL DATA

Overall Length	14.23 m / 46'8"
Waterline length	14.16 m / 46'6"
Beam overall	7.54 m / 24'9"
Draft	1.20 m / 3'11"
Unloaded weight (approx.)	15 t / 33 075 lbs
Engine	Diesel, V-Drive
Engine power - standard	2 x 225 hp Volvo Penta
Engine power - option	2 x 300 hp Volvo Penta
Fuel tank	2 x 645 L / 2 x 177 gal
Fresh Water tank	2 x 300 L / 2 x 79 us gal
Cabins - Heads	3 à 4
Berths	6 à 8
Architect	Marc Lombard



NAUTITECH

MAKE
EXCELLENCY
YOUR STANDARD

NAUTITECH CATAMARANS: THE PERFECT BALANCE BETWEEN PERFORMANCE AND COMFORT

My relationship with NAUTITECH CATAMARANS, started in 2009 with the design of the Nautitech 54'. The brief was to create the perfect balance between performance and comfort, for private customers who are keen sailors but want the comforts of modern living too. We also wanted to appeal to sailors who charter a yacht, but do not want it to just be a floating caravan. What I mean by «performance» is genuine sensations at the helm, good top speed when conditions are favourable, and more specifically, high average speed upwind and downwind, without forgetting the important aspect of the time spent motoring, which is frequent with long-distance cruising. And all this without ever having to worry about safety in family navigation conditions. On deck everything is designed to be simple and reliable, easy to be manoeuvred by a reduced crew.

Marc LOMBARD
Naval Architect

A LONG-TERM VISION PROMOTING EXCELLENCY

Running a successful shipyard is a dream come true for the team behind NAUTITECH CATAMARANS. Passion for the sea and shipbuilding is shared throughout every department, and this passion is a fundamental foundation for our company. We believe that navigation must be at the heart of a multihull's DNA. While the current market trend increasingly promotes the catamaran experience as a static one, we design boats that are remarkable when stationary and when blue water cruising. Our customers expect us to be able to sail by maximizing their experience on the water as well as the sensations felt. It is therefore imperative for us to project the future of our catamarans in solutions combining ease of use, comfort in navigation, performance, safety in all wind conditions.

Gildas LE MASSON
CEO



THE BRAND

It is in Rochefort sur Mer, the very cradle of shipbuilding and naval architecture and birthplace of Pierre Loti, that NAUTITECH CATAMARANS has anchored its activity of construction of luxury catamarans. Anyone familiar with the world of multihulls can quickly appreciate the innovative nature of NAUTITECH CATAMARANS, the first manufacturer to understand and define the very spirit of a catamaran. Nautitech were also the first to propose the concept of open living onboard, that combines the saloon and cockpit into one spacious, functional living area. Understanding how important sensations at the helm are to their customers, NAUTITECH CATAMARANS places equal emphasis on sailing ability and comfort.





www.nautitechcatamarans.com